

NOTES:

1. 材質:
 - 1.1 膠芯: LCP+30%G.F.
 - 1.2 端子: C7025, T=0.15mm, 鍍半金錫
 - 1.3 外殼: 不銹鋼, T=0.17mm. 表面鍍銀
 - 1.4 卡鉤: 不銹鋼, T=0.30mm. 表面鍍錫
 - 1.5 彈片: 不銹鋼, T=0.10mm
2. 主要特性:
 - 2.1 額定電流: 0.5A
 - 2.2 接觸阻抗: 40Megohms MAX
 - 2.3 絕緣阻抗: 100Megohms MIN 250V DC
 - 2.4 耐壓測試: 100V AC
 - 2.5 沾錫性: 溫度250±5° C
 - 2.6 整體插入力: 2.0kgf MAX
整體拔出力: 0.8kgf MIN
 - 2.7 使用壽命: 10000次
 - 2.8 工作溫度: -30° C ~ +80° C

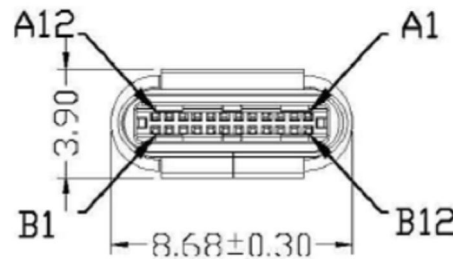

w/	15u"	C023850-04
	FLASH	C023850-03
w/o	15u"	C023850-02
	FLASH	C023850-01
PANEL	GOLD PLATED	PART NUMBER

THIS DRAWING IS A CONTROLLED DOCUMENT.		DWN 尹晚開 22SEP2015	CHUFON TECH. CO., LTD.			
DIMENSIONS: MM		CHK 楊廣文 22SEP2015				
TOLERANCES UNLESS OTHERWISE SPECIFIED:		APVD 林振偉 22SEP2015	NAME			
0 PLC ± - 1 PLC ± 0.30 2 PLC ± 0.20 3 PLC ± 0.15 4 PLC ± - ANGLES ± 3°		PRODUCT SPEC	USB 3.1 TYPE C, PLUG			
MATERIAL SEE NOTE		QUALIFICATION TEST REPORT	SIZE A3	CAGE CODE 00779	DRAWING NO C023850	RESTRICTED TO -
FINISH SEE NOTE		WEIGHT	CUSTOMER DRAWING		SCALE -	SHEET 1 of 2
						REV A0

4

3

2

1

TOP SHELL

BOTTOM SHELL

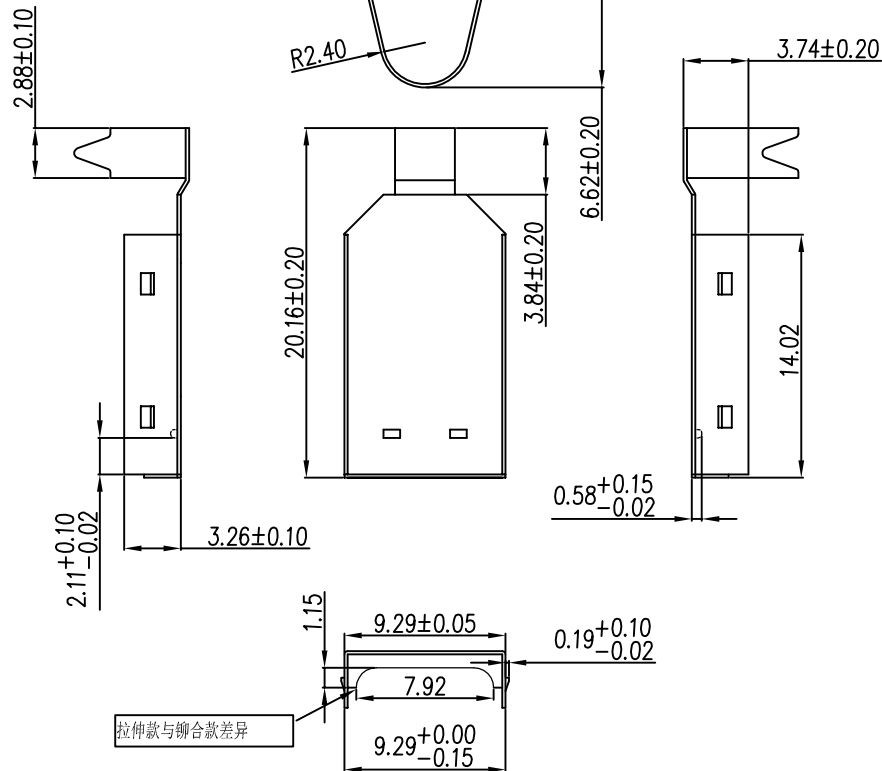
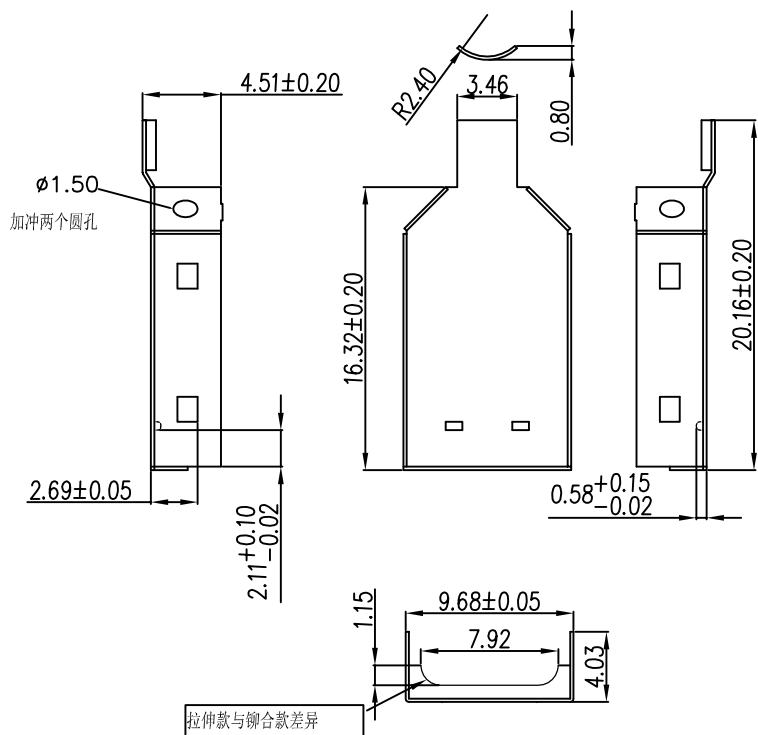

NOTES:

1. 材质: 不锈钢SUS201, T=0.20±0.02mm.
2. 外观不允许有压伤, 脏污, 模痕等不良现象.
3. 非功能处毛边最大0.03MM.
4. 上盖与下盖/半成品需实配OK.

W/	15u"	C023850-04
	FLASH	C023850-03
W/O	15u"	C023850-02
	FLASH	C023850-01
PANEL	GOLD PLATED	PART NUMBER

THIS DRAWING IS A CONTROLLED DOCUMENT.		DWN 尹晚開 22SEP2015	CHUFON TECH. CO., LTD.		
DIMENSIONS: MM		CHK 楊廣文 22SEP2015	NAME		
TOLERANCES UNLESS OTHERWISE SPECIFIED:		APVD 林振偉 22SEP2015	PRODUCT SPEC		
0 PLC ± -		QUALIFICATION TEST REPORT			
1 PLC ± 0.30		SIZE CAGE CODE DRAWING NO RESTRICTED TO			
2 PLC ± 0.20		A3 00779 C023850 -			
3 PLC ± 0.15		CUSTOMER DRAWING SCALE - SHEET 2 OF 2 REV A0			
4 PLC ± -					
ANGLES ± °					
FINISH					
SEE NOTE					